

Crushing & mill technology

Grinding & dispersing

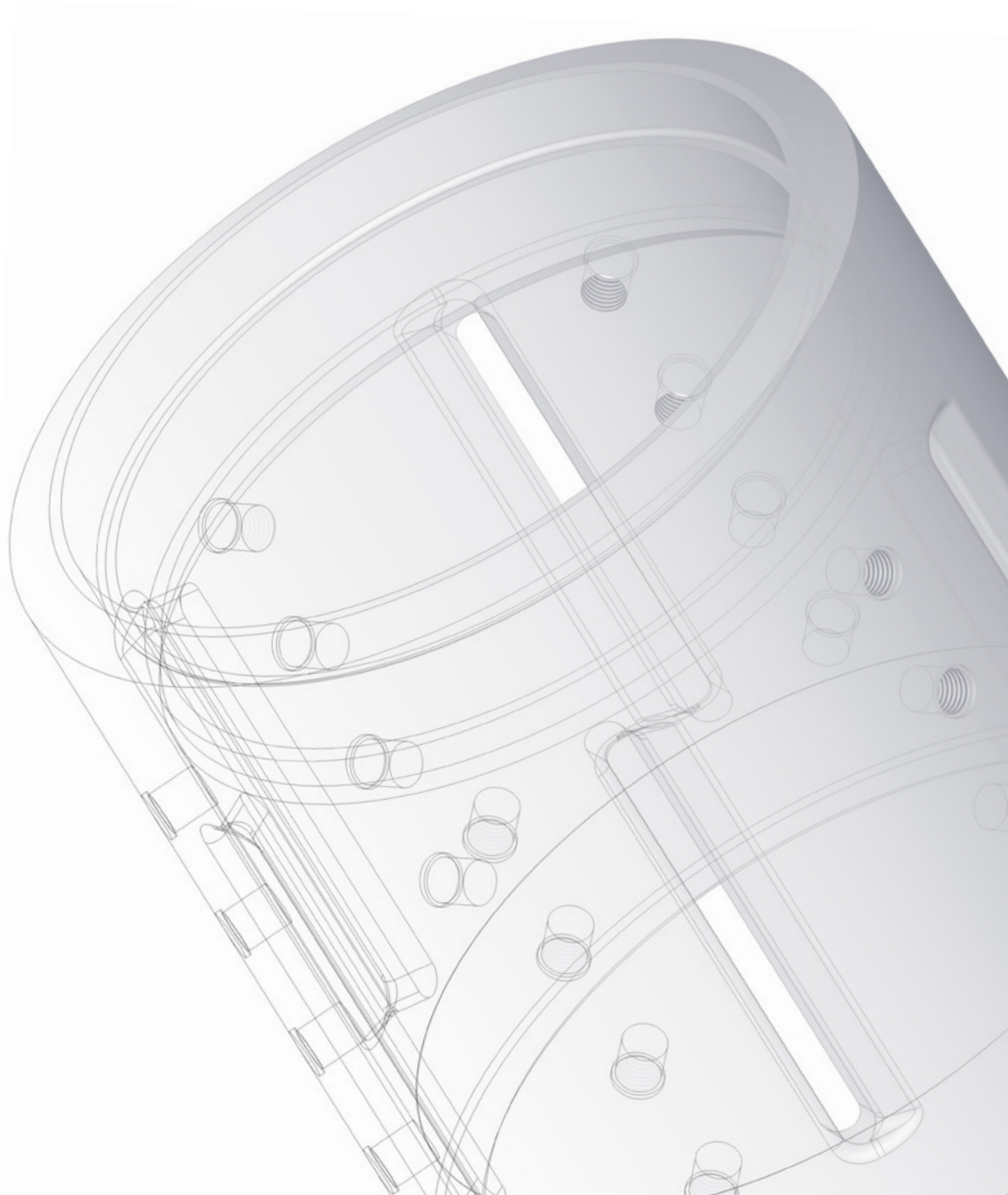

Components for your crushing machines and mills

Innovation based on material expertise

There is a growing worldwide demand for stronger materials, increased service life and greater performance, when it comes to the components of crushing machines – such as ball and roller mills – which come into contact with the material being handled.

We meet our customers' demands in this respect with ready-to-install stainless steel components made using the centrifugal casting process.

Our components offer you considerable advantages:

- Cost-conscious, customised advice regarding materials
- Ongoing materials development by our team of experts in metallurgy
- Abrasion- and corrosion-resistant special materials optimised for the task in hand
- Maximum precision according to your specifications, with hardness of up to 65 HRC

Customised solutions

Kuhn Special Steel is your first choice when it comes to producing and machining ready-to-install milling components of all sizes and in a huge variety of materials. We not only offer several decades of experience in centrifugal casting but also the most modern and widest-ranging machinery park of a centrifugal casting foundry worldwide.

As a world-class market leader, we deliver thousands of top-quality components every year.

We are thus able to supply ready-to-install components with external diameters of up to 39".

We offer in-house expertise and reliability in all our machining, drilling, milling, heat-treatment and test procedures.

Fields of application

Homogenising, mixing, dispersing, emulsifying, crushing and grinding

Crushing & mill technology

Range of dimensions: 3 to 39"

Materials:

- **Chromium white cast iron:** e.g. K202 / 0.9645; 1.4195
- **Ferritic and martensitic steels:** e.g. K030 [*1.4108*]; K4112 [*1.4112*]; K4122 [*1.4122*]
- **Soft martensitic steels:** e.g. K509 (1.4405-S)
- **Austenitic-carbidic cast iron:** e.g. 1.4091
- **Ferritic-carbidic cast iron:** e.g. GL 21

Rotor



Stator



Bowl

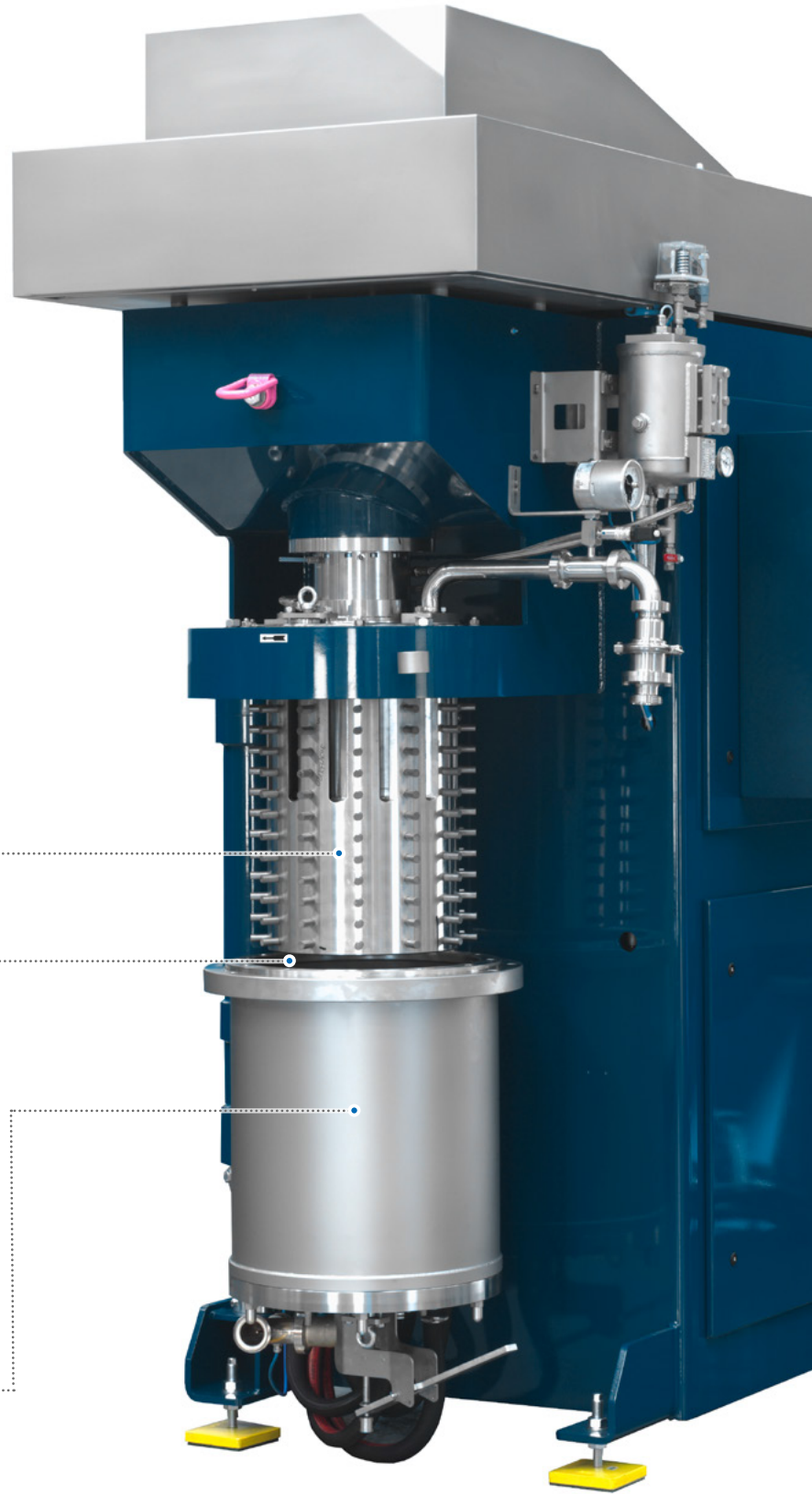

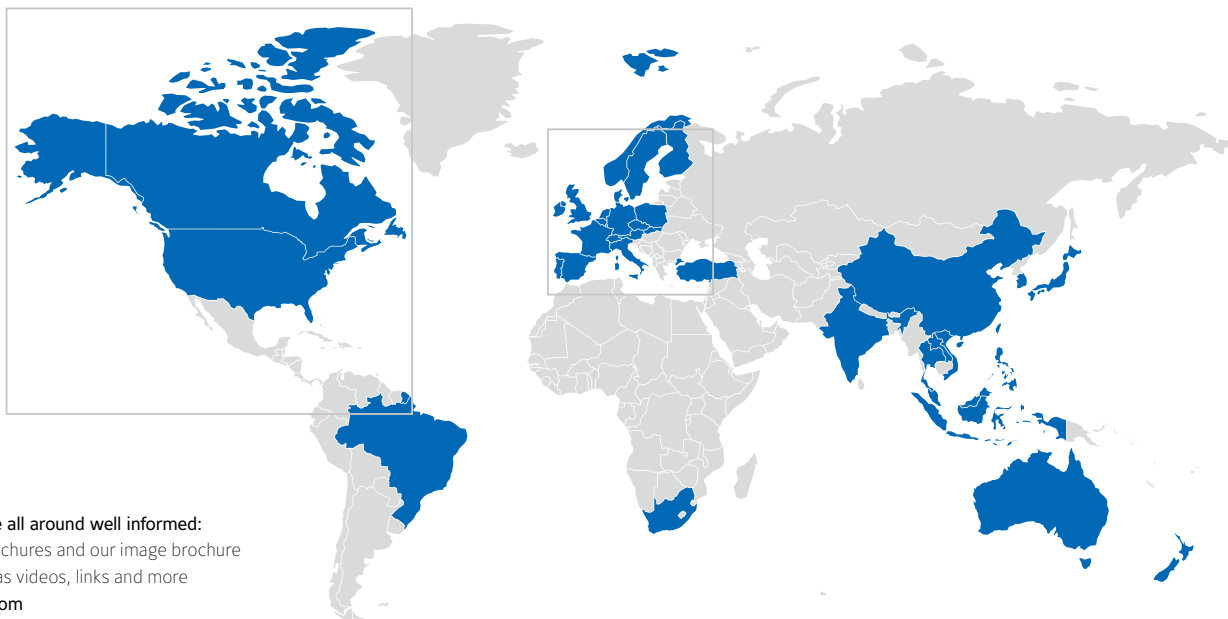

Scan QR code and be all around well informed:
 All sector-specific brochures and our image brochure
 as download, as well as videos, links and more
info.kuhn-edelstahl.com

Our global presence

Kuhn Special Steel – Reliable solutions. Always.

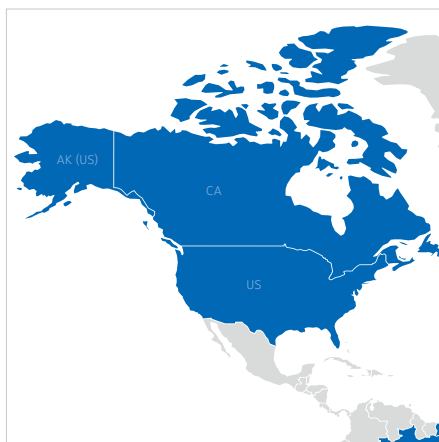
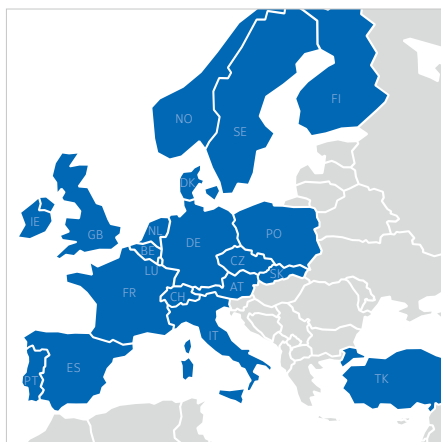

Klaus Kuhn Edelstahlgießerei GmbH

Otto-Hahn-Straße 12-14
 42477 Radevormwald
 Germany

Phone: +49 (0) 2195 671 - 0
 Fax: +49 (0) 2195 671 - 49

info@kuhn-edelstahl.com
www.kuhn-edelstahl.com

 www.facebook.com/KuhnEdelstahl

Kuhn Special Steel North America, Inc.

C/O Rödl Langford de Kock LLP
 55 West Monroe Street, Suite 2900
 Chicago, IL 60603, USA

Phone: +49 (0) 2195 671 - 921
 Cell: +49 (0) 170 9267425

sales@kuhn-northamerica.com
www.kuhn-northamerica.com